



**SERENGETI  
MOTORSPORTS**

[www.SerengetiMotorSports.com](http://www.SerengetiMotorSports.com)

# OWNER'S MANUAL

**Read Instructions Before Using Your New 500W Scooter**



**Model No. : MS-SS501**

Page 1

## TABLE OF CONTENTS

TABLE OF CONTENTS.....	2
IMPORTANT INFORMATION.....	3-4
QUICK REFERENCE.....	5
GETTING TO KNOW YOUR SCOOTER.....	6
PACKAGE CONTENTS.....	7
GETTING STARTED.....	7
ASSEMBLY.....	7-8
FUSE INSTALLATION.....	8
SEAT & SEAT POST INSTALLATION.....	8
CHARGING.....	9
RIDING/BRAKING.....	9
FOLDING AND STORAGE.....	10
BRAKING SYSTEM.....	10
ADJUSTING BRAKES.....	10
TIRE PRESSURE.....	11
MAINTENANCE.....	12
RECOMMENDED TOOLS.....	12
ADJUSTING THE HEAD UNIT.....	12
ADJUSTING THE CHAIN.....	12-13
MAINTENANCE SCHEDULE.....	13
TROUBLESHOOTING GUIDE.....	14
OTHER QUESTIONS.....	14

PLEASE BE SAFE WHEN RIDING

ALWAYS WEAR A HELMET AND OBEY ALL LAWS!



**IMPORTANT**



**BATTERY MAINTENANCE and**  
**CHARGING INSTRUCTIONS**

1. You **MUST** charge completely prior to initial use. (Follow charging instructions in your Product Handbook)
2. Charge immediately after each use.
3. Charge before storage. You must charge every 30 days if not in use.
4. Charge the unit for 6-8 hours or until the light on the charger turns red & green.
5. **DO NOT** allow this unit to deep discharge the battery.
6. For safety purposes, **DO NOT** charge for over 24 hours.
7. Turn the unit **OFF** when not in use.

Failure to follow these **INSTRUCTIONS** will  
**VOID YOUR WARRANTY!**

This **PRODUCT IS NOT INTENDED FOR EXTREME or OFF-ROAD Use!** Please take care of your MS-SS501!

**DO NOT JUMP or ABUSE THIS PRODUCT!**

**DO NOT RIDE IN WET/ICY CONDITIONS!**

Failure to follow these instructions will  
**VOID YOUR WARRANTY!**

**DO NOT RETURN STORE** For questions regarding assembly and use, call  
Customer Service: 888-896-6881.

# IMPORTANT

PLEASE READ THIS BEFORE USING THIS PRODUCT

**READ THIS FIRST!**

## WARNING

This product does not conform to Federal Motor Vehicle Standards and is not intended for operation on public streets, roads or highways. Serious injury can result from the unsafe operations of this product. Operator can minimize these risks by using certain safety equipment such as: safety helmet, goggles, gloves, elbow and kneepads and appropriate footwear.

DO NOT operate this product in traffic, on wet, frozen, oily or unpaved surfaces or under the influence of drugs and/or alcohol. Avoid uneven surfaces, potholes, surface cracks and obstacles.

DO NOT use a water hose to clean this product. See Product Handbook for more information.

This product is recommended for riders 13 YEARS OF AGE and older.

## SAFETY

- Persons without excellent vision, balance, coordination, reflex, muscle and bone strength and good decision-making capabilities should not use this product.
- Minors without adult supervision should not use this product.
- Persons unwilling or unable to take responsibility for their own actions should not use this product.
- The user of this product assumes ALL risks associated with its use. To minimize these RISKS, the user must wear safety helmet, goggles, gloves, elbow and kneepads and appropriate footwear.
- This product is ELECTRIC! DO NOT ride this product in wet conditions, puddles or rainy weather.

**DO NOT RETURN STORE** For questions regarding assembly and use call  
Customer Service: 888-896-6881

## QUICK REFERENCE SAFETY GUIDE

### SAFETY GUIDE

- The recommended minimum age for riding this scooter is 13 years old.
- To avoid damage to the motor and footplate, do not overload the scooter.
- Never ride with more than one person.
- Inspect your scooter thoroughly before each use for loose or missing parts.
- Avoid unintentional starts by turning the scooter off while not in use.
- To avoid the risk of a short circuit in the electrical parts, do not use your Electric scooter in the rain and never spray or wash off your scooter with water.
- Do not place the battery near fire or heat.
- To avoid damage to the battery, do not use the charger if it has been damaged in any way.
- Keep hands, face, feet and hair away from all moving parts.
- Do not touch the motor or wheels while they are rotating.
- Brakes are designed to control speed as well as stop the scooter. Practice braking for proper slowing down and smooth stops.
- Maintain your SCOOTER as recommended in this Product Handbook.
- Use only quality replacement parts as recommended by the manufacturer.
- Inspect the entire scooter prior to each use. Replace any part that is cracked, chipped or damaged before use.

**\*NEVER ALLOW CHILDREN TO OPERATE THE SCOOTER WITHOUT ADULT SUPERVISION.**

**\*NEVER ATTEMPT TO OPERATE THE SCOOTER WHILE UNDER THE INFLUENCE OF ALCOHOL.**

**If a situation arises that is not covered in the manual,  
proceed with caution and use good judgment.**

**Contact your dealer  
if you need further assistance**

**DO NOT RETURN STORE. For questions regarding assembly and use, call  
Customer Service: 888-896-6881.**

## GETTING TO KNOW YOUR SCOOTER

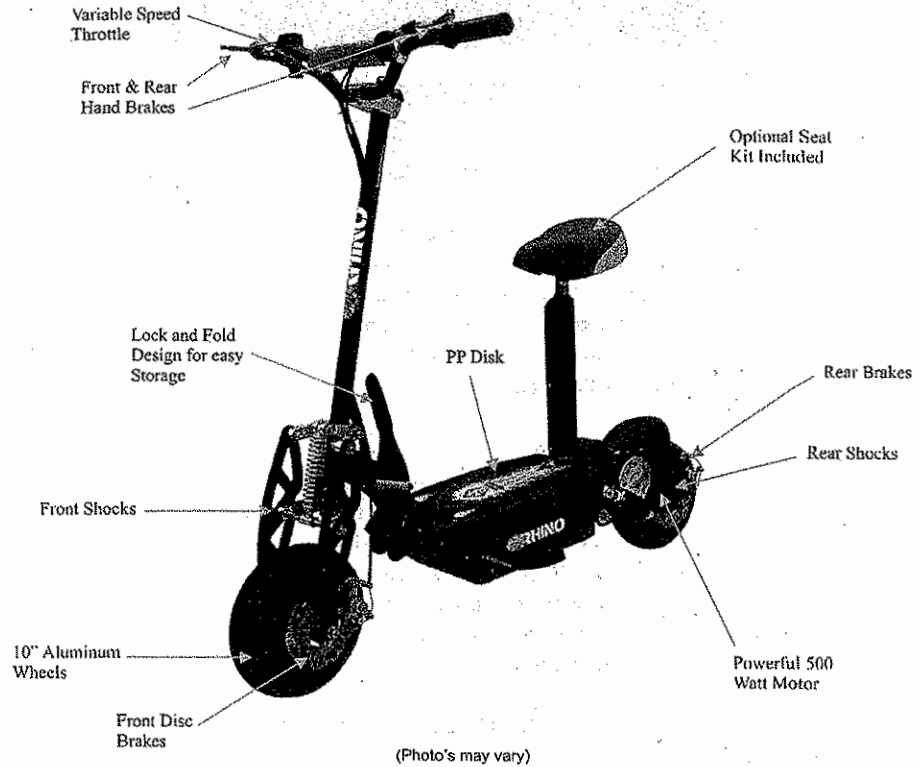



**DO NOT RETURN STORE.** For questions regarding assembly and use, call Customer Service 888-896-6881

## PACKAGE CONTENTS

Your Scooter comes with the following items in the box. Please locate all of the following:

1. Scooter
2. 36V Battery Charger
3. Tool Kit User Manual and 25 amp Fuses
4. Seat
5. Seat Post & Clamp

## GETTING STARTED

 Please read and understand these instructions and the OPERATING PROCEDURES section, prior to starting or riding your MS-SS501 

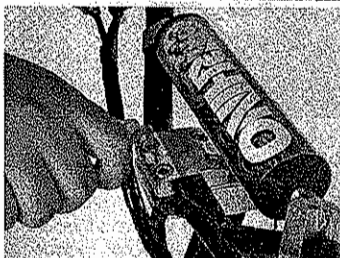
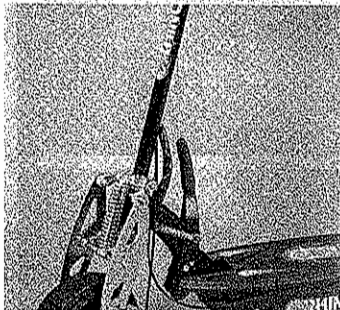
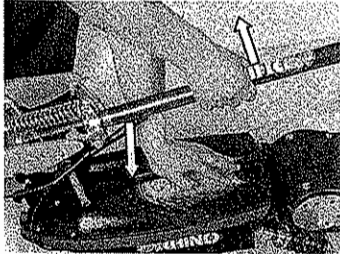

### Assembly

1. Carefully remove the scooter from the box. Then install the wheels please.
2. To unfold the scooter, begin by pressing down on the FOLDING HANDLE with one hand while gently pulling up on the handlebars with the other.
3. Fully extend the handlebars to their upright position until you feel the mechanism lock into place.
4. Attach the handlebars by inserting the silver handlebar clamp onto the handlebar post stopping just below the top. Be sure to orient the bars in the correct riding position with the throttle on the rider's right side. Secure the handlebars to the post by tightening the bolts on the clamp with the enclosed Allen wrench as shown.
5. Secure the hand brakes in place by using the provided Allen Wrench to first loosen the tension bolts. Adjust the levers to a comfortable position and tighten the bolts. **\*BE CAREFUL NOT TO PULL ON THE CABLES!**

**DO NOT RETURN STORE** For questions regarding assembly and use, call  
Customer Service: 888-896-6881

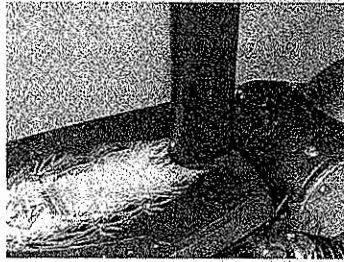
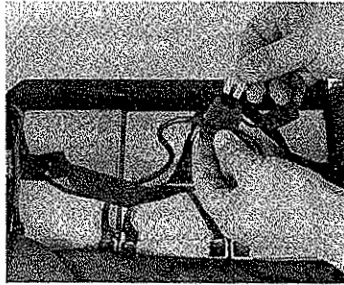
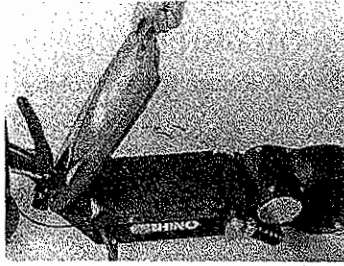

Assembly – Cont:

6. Insert the 25 amp fuse by opening the footplate cover as shown. Insert the fuse into the fuse holder then close the footplate cover.
7. Attach the seat post to the seat post receiver, then attach the clamp to the top of the seat post. Pull the upper seat post to the desired position and tighten the clamp securely.
8. Attach the seat to the upper seat post and tighten the seat bolts as shown.

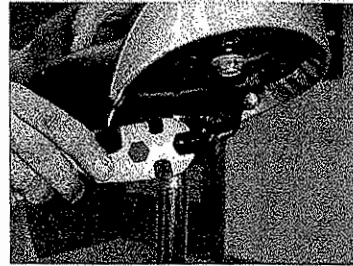
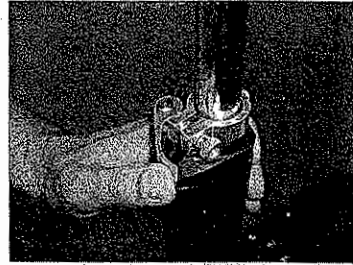

DO NOT RETURN STORE For questions regarding assembly and use call  
Customer Service 888-896-6881



## **CHARGING**

Your scooter comes charged out of the carton. We still recommend charging the unit for 6-8 hours prior to its first use. We also recommend charging your scooter after each use and prior to storage.

**WARNING:** Do not allow your scooter to go into deep discharge, as this will damage the batteries.

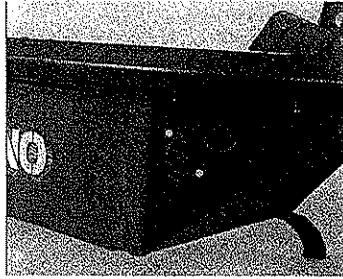

1. Make sure unit is turned off.
2. Open the charging socket cover located on the right side of the scooter frame, under the footplate.
3. Locate your Battery Charger. Find the charger socket end that has a three-prong socket and plug it into the scooter.
4. Next, plug the AC plug into a wall outlet.

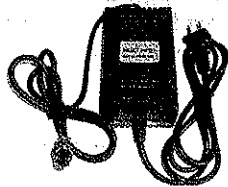

When first plugged in, the charger has one red light that will illuminate at the same time, indicating that the charging process has started. Once the light on the charger turns red & green, you may remove the charger and close the safety cap.

## **RIDING**

1. Make sure that all of the exposed bolts and screws are tightened.
2. Raise the kickstand to its upright position.
3. Push the on/off switch (located on the left handlebar) to the ON position.
4. Put one foot on the deck of the MS-SS501 while pushing off with the other foot, gently rotate the THROTTLE GRIP, on the right side of the handlebars. The MS-SS501 will begin to move on its own power.

\*\*Your scooter has a variable speed hand throttle. You can control the speed of your scooter by the amount of pressure you use when rotating the hand throttle. The more you rotate, the faster you will go.

## **STOPPING & BRAKING**

1. To brake, release the THROTTLE GRIP and depress the BRAKE LEVERS (on the left/right side of the handlebars). Depressing the brake will disengage power to the motor. When the unit feels like it is losing power or not accelerating to full speed,

**DO NOT RETURN STORE** For questions regarding assembly and use, call  
Customer Service: 888-896-6881

the scooter is ready to be re-charged.

NOTE: If the on/off switch is left in the ON position for more than 10-15 minutes without moving, Smart Power will shut itself OFF. To reset, turn the unit OFF, wait a few seconds and then switch it back ON again.

### **FOLDING & STORAGE**

When you are done riding the MS-SS501 you can fold it down for compact storage and transportation. First remove the seat post and seat, then using one hand, push down on the folding handle while gently pushing down on the handlebars. **BE CAREFUL NOT TO HIT YOUR HEAD WITH THE HANDLEBAR, SET YOURSELF AT THE RIGHT SIDE IS NECESSARY.** Push down until you feel the mechanism lock into the down position.



### **BRAKING SYSTEM**

The scooter uses a pinch braking system for the front, and a disc/caliper system for the rear. They are both activated by a hand brake lever on the left and right side of the handlebar. Squeezing the hand brake lever with your left hand activates the rear brake. Squeezing the hand brake lever with your right hand activates the front brake. Make sure to release the HAND THROTTLE GRIP when engaging the brakes. Your MS-SS501 is equipped with switches on each brake lever that will disengage power to the motor when the brake levers are depressed.

Practice braking on a smooth, dry surface to get used to the feel of the braking system. Braking distance is affected by wet conditions and loose and uneven riding surfaces.

### **Adjusting the Brakes**

The Brakes on the scooter should come fully adjusted from the factory. However, it may be necessary to adjust the brakes from time to time.

To adjust the rear brakes:

For brakes that are adjusted too loose:

1. Adjust the tension screw on the right hand brake lever by rotating it counter-clockwise until the wheel spins freely.

For brakes that are adjusted too tight:

2. Tighten the tension screw on the right hand brake lever by rotating it clockwise until the wheel has a slight drag.

**DO NOT RETURN STORE** For questions regarding assembly and use, call  
Customer Service: 888-396-6883

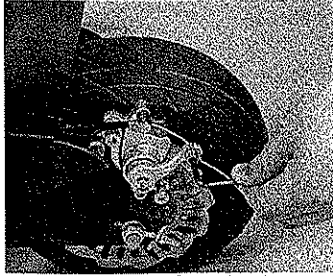

To adjust the front brakes:

For brakes that are adjusted too loose:

3. Adjust the tension screw on the left hand brake lever by rotating it counter-clockwise until the wheel spins freely.

For brakes that are adjusted too tight:

4. Tighten the tension screw on the left hand brake lever by rotating it clockwise until the wheel has a slight drag.

For Further Front Brake Adjustment

5. Locate the adjustment screw on the front brake assembly (located above the front wheel). Tighten or loosen as necessary.

For Further Rear Brake Adjustment

6. Locate the adjustment screw on the rear brake assembly ( Located on the left side of the back wheel. Tighten or loosen as necessary.

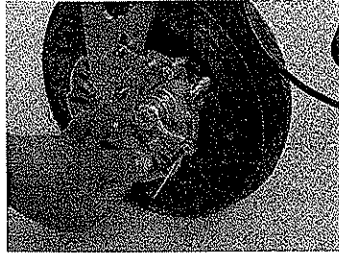

### **SQUEAKY BRAKES**

The brakes may squeak before they are broken in. This is normal and will not affect the function or performance of the brakes. With continued use the squeak should go away.

### **TIRE PRESSURE**

The tire must be inflated to a maximum of 50 P.S.I. It is also recommended to use a tube additive like **Slime**, available from any motorcycle shop, to avoid inconvenient punctures.

Empty all air from the tire, prior to loosening the bolt to split the rim.

### **MAINTENANCE**

#### **RECOMMENDED TOOLS**

To adjust and service the scooter you will need the following tools:

- Allen Wrenches: 3/4/5/6 mm

**DO NOT RETURN STORE** For questions regarding assembly and use call  
Customer Service: 888-896-6884

- Wrenches: 10/13/13 mm Open end wrench
- Large Adjustable Crescent Wrench
- Philips Head Screwdrivers
- Oil, Grease or Lubricant

### **ADJUSTING THE HEAD UNIT**

The head unit will come adjusted from the factory. However, riding on rough terrain and general use may cause the head unit to become loose over time. It may be necessary to adjust the head unit from time to time.

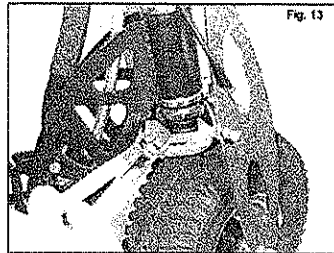

To adjust the head unit:

1. Rotate the handle bar as far right as it will go to expose the HEAD UNIT. (see fig left)
2. Using a large adjustable wrench, gently turn the BEARING LOCK clockwise to tighten. \*DO NOT OVER TIGHTEN OR IT WILL DAMAGE THE BEARINGS.

### **ADJUSTING THE CHAIN**

The chain will come adjusted from the factory. However, it may be necessary to adjust the chain from time to time. The chain must be well aligned onto the sprockets in order to avoid uneven wear. This will result in shortened chain life.

#### How tight should the chain be?

- If the chain is skipping or jumping on the sprockets, this is too loose and may be harmful.
- If the chain is making a humming sound when the wheel is turning, this is too tight and may cause the chain to snap.
- The correct tension is achieved by adjusting the chain from its loose position to when it becomes lightly tense.

**DO NOT RETURN STORE** For questions regarding assembly and use, call Customer Service: 888-896-6881

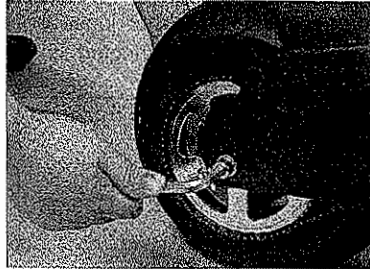
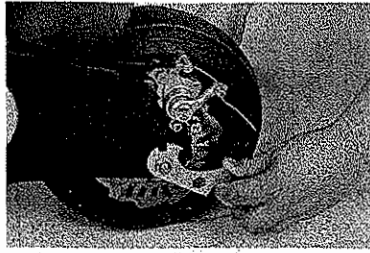

To tighten the chains:

Slightly loosen the two axle bolts on both sides of the rear wheel. Then slowly adjust the two adjusting screws on each side of the rear tire until chain reaches the proper tension.

Rotate the rear wheel to make sure the chain is aligned.

Finally, lock and tighten the rear axle bolts prior to riding.

## MAINTENANCE SCHEDULE

Proper care of your scooter will insure optimal performance and longer life span. The following are a few maintenance suggestions that will keep your scooter running in top condition:

### Daily Maintenance

Perform each time you ride your scooter

- Clean the exterior of the unit with a soft, damp rag. (DO NOT WASH WITH A HOSE)
- Check that all nuts and bolts are securely tightened.
- Lubricate the chain with any silicone spray, 3&1 oil or any good clean motor oil.
- Check battery charger for any frayed/cut wires.

DO NOT RETURN STORE - For questions regarding assembly and use, call Customer Service: 888-896-6581

### TROUBLESHOOTING GUIDE

SYMPTOMS	POTENTIAL CAUSE	SOLUTION
The charger light turns green & red right away	<ol style="list-style-type: none"> <li>1. This indicates the batteries are adequately charged.</li> <li>2. Bad Fuse or open connection between charger socket and batteries.</li> </ol>	<ol style="list-style-type: none"> <li>1. Continue to charge the batteries for 6-8 hours prior to initial use.</li> <li>2. Check Fuse: Look for loose or disconnected wire</li> </ol>
Batteries do not hold a charge. Unit does not have specified travel range.	<ol style="list-style-type: none"> <li>1. Batteries have reached the end of their useful life.</li> <li>2. Charger is malfunctioning.</li> </ol>	<ol style="list-style-type: none"> <li>1. Replace Batteries</li> <li>2. Replace Charger Unit.</li> </ol>
Unit moves intermittently or very slow.	<ol style="list-style-type: none"> <li>1. Batteries not fully charged.</li> <li>2. Loose Wire.</li> <li>3. Bad Throttle or controller.</li> </ol>	<ol style="list-style-type: none"> <li>1. Charge or replace batteries.</li> <li>2. Check for loose wires</li> <li>3. Replace</li> </ol>
Unit will not move when throttle lever is activated.	<ol style="list-style-type: none"> <li>1. Batteries not fully charged.</li> <li>2. Brake switches out of adjustment</li> <li>3. Batteries have reached the end of their useful life.</li> </ol>	<ol style="list-style-type: none"> <li>1. Replace batteries or charger.</li> <li>2. Loosen brakes</li> <li>3. Replace batteries.</li> </ol>
Unit stops abruptly during use.	<ol style="list-style-type: none"> <li>1. Fuse Blown</li> <li>2. Loose or broken wire.</li> </ol>	<ol style="list-style-type: none"> <li>1. Replace Fuse</li> <li>2. Check for loose or broken wires and repair/replace.</li> </ol>

### OTHER QUESTIONS

*For additional questions, service instructions, further information and important phone numbers, please go to scooter website at [www.UPCintl.com](http://www.UPCintl.com)*

Thank you for purchasing and please tell your friends how much fun you're having on the scooter

**DO NOT RETURN STORE** For questions regarding assembly and use call Customer Service: 888-896-6881

# **SPECIFICATION**

**Brand: SERENGETI MOTORSPORTS**

**Model No. : MS-SS501**

**Motor Power : 500W**

**Battery : 36V/ 12Ah**

**Max Load : 250lbs**

**Net Weight : 83.5lbs**

**Made in China**



## Scooter Parts Information

Model No.: MS-SS501



## PART-A front wheel

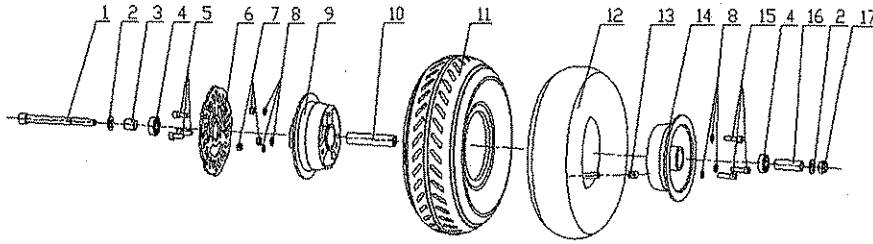

Item	Name	Specification/Size	Qty
A-1	bolt	M10×170	1
A-2	washer	Φ20×Φ10.5×1.5	2
A-3	spacer	Φ15×Φ10.1×15	1
A-4	bearing	6000	2
A-5	bolt	M6×15	3
A-6	Disk, brake	Φ130	1
A-7	locknut	M6	3
A-8	washer	Φ11×Φ6.4×1	3
A-9	hub, wheel		1
A-10	spacer	Φ15×Φ10.1×72.8	1
A-11	tire	10in	1
A-12	tube		1
A-13	inflation spot		1
A-14	Hub, wheel		1
A-15	bolt	M6×25	3
A-16	spacer	Φ15×Φ10.1×40	1
A-17	bolt	M10	1

## PART-B rear wheel

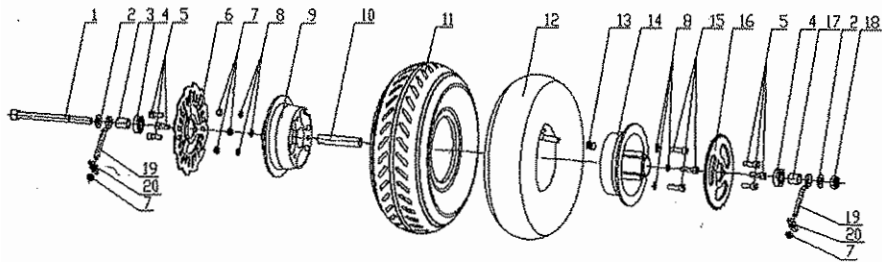

Item	Name	specification/size	QTY
B-1	bolt	M10×170	1
B-2	washer	Φ20×Φ10.5×1.5	2
B-3	spacer	Φ15×Φ10.1×17.5	1
B-4	bearing	6000	2
B-5	bolt	M6×15	6
B-6	Disc brake	Φ140	1
B-7	locknut	M6	5
B-8	washer	Φ11×Φ6.4×1	6
B-9	Hub, wheel		1
B-10	spacer	Φ15×Φ10.1×94.5	1
B-11	tire	10in	1
B-12	tube		1
B-13	Inflation spot		1
B-14	Hub, wheel		1
B-15	bolt	M6×25	3
B-16	Chain sprocket	55th	1
B-17	spacer	Φ15×Φ10.1×15.5	1
B-18	Nut, locknut	M10	1
B-19	Tensioner set		2
B-20	Tensioner set		2

## PART-C rear part

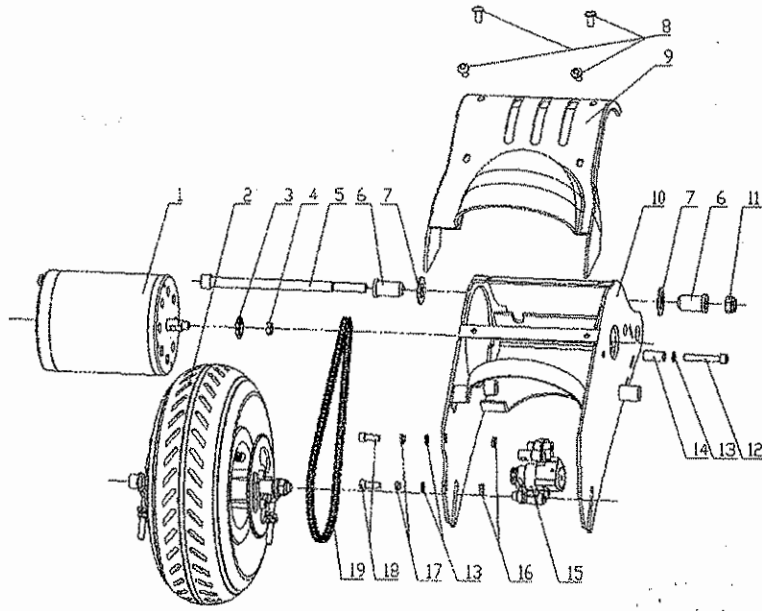

Item	Name	specification/size	QTY
C-1	motor	800W	1
C-2	Rear Wheel set		1
C-3	Small sprocket	11th	1
C-4	nut	M6	1
C-5	bolt	M10×170	1
C-6	spacer	Φ16×Φ10×30	2
C-7	washer	Φ16×Φ30×1.5	2
C-8	bolt	M6×12	4
C-9	mudguard		1
C-10	frame		1
C-11	Nut, locknut	M10	1
C-12	bolt	M6×40	1
C-13	washer	Φ11×Φ6.4×1	3
C-14	Spacer for motor	Φ12×Φ7×25	1
C-15	caliper		1
C-16	washer	Φ11×Φ6.4×2	2
C-17	Spring, washer		2
C-18	bolt	M6×16	2
C-19	chain	96kts	1

## PART-D Handler Bar

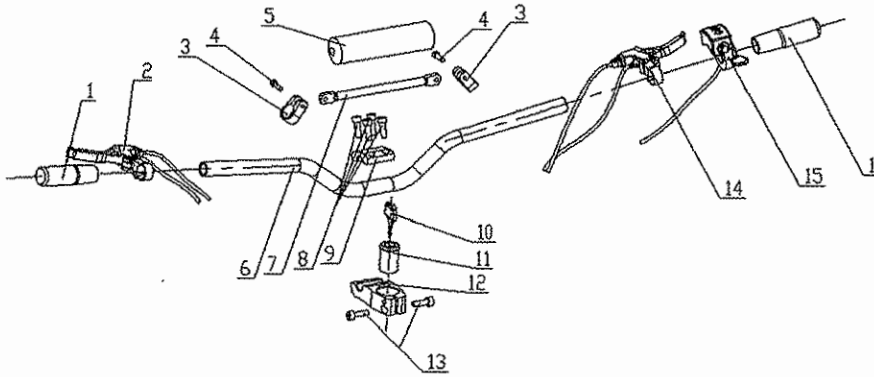

Item	name	specification/size	QTY
D-1	grip		2
D-2	Rear brake lever		1
D-3	nut		2
D-4	bolt	M6×20	2
D-5	Spongy sticker		1
D-6	Handlebar		1
D-7	Handlebar		1
D-8	bolt	M8×20	4
D-9	Stem, steering		1
D-10	Key		1
D-11	Key switch		1
D-12	Stem, steering		1
D-13	bolt	M8×25	2
D-14	Front brake lever		1
D-15	throttle		1

## PART-E front suspension

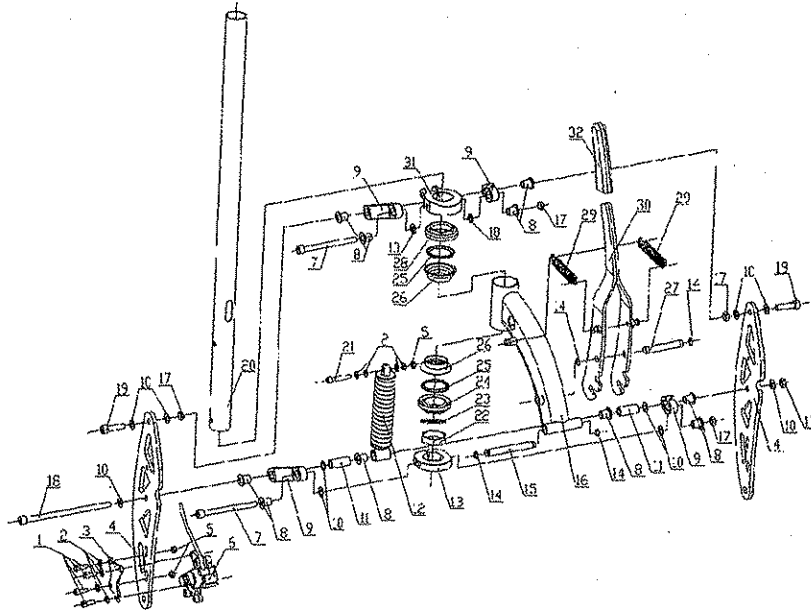

Item	Name	specification/size	QTY
E-1	screw		1
E-2	washer		
E-3	Caliper support		5
E-4	fork		2
E-5	nut		2
E-6	caliper		1
E-7	bolt		1
E-8	screw		1
E-9	rocker		1
E-10	washer		1
E-11	spacer		1
E-12	shock		1
E-13	Locking ring		1

E-14	Snap spring		1
E-15	Neck support		2
E-16	neck		4
E-17	Locknut		1
E-18	bolt		2
E-19	bolt		1
E-20	Handle pipe		2
E-21	bolt		1
E-22	Heap cut set		1
E-23	Heap cut set		1
E-24	Heap cut set		1
E-25	Heap cut set		1
E-26	Heap cut set		1
E-27	bolt		1
E-28	Heap cut set		1
E-29	spring		4
E-30	Folding handle		2
E-31	bolt		1
E-32	Lock ring		1
E-33	rubber		1
E-34			1

## PART-F Frame

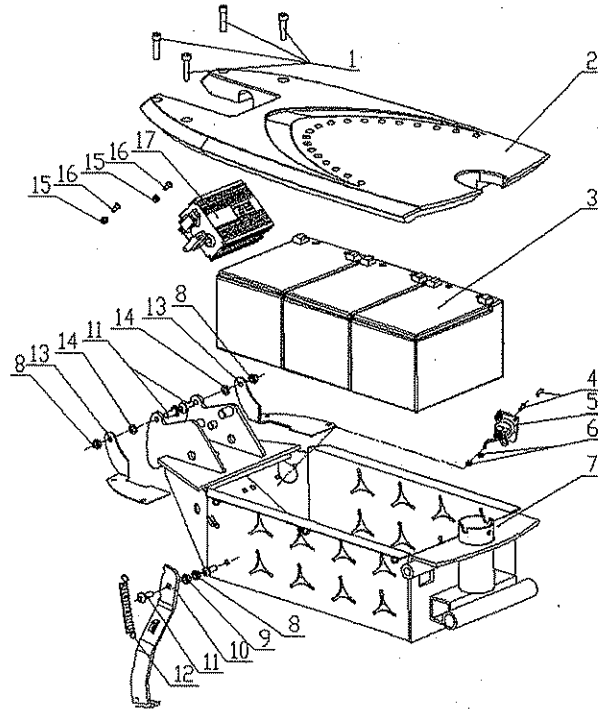

Item	Name	specification/size	QTY
F-1	bolt	M6×25	4
F-2	Foot deck		1
F-3	battery	12V/12Ah	3
F-4	bolt	M3×13	2
F-5	Charger spot		1
F-6	nut	M3	2
F-7	Battery box		1
F-8	locknut	M6	1
F-9	nut	M6	1
F-10	Kick stand		1
F-11	bolt	M6×16	3
F-12	spring		1
F-13	Left/right connect		2
F-14	washer	Φ11×Φ6.4×1	2
F-15	locknut	M4	2
F-16	bolt	M4×10	2
F-17	controller	30A/800W	1

## PART-G Rear shock

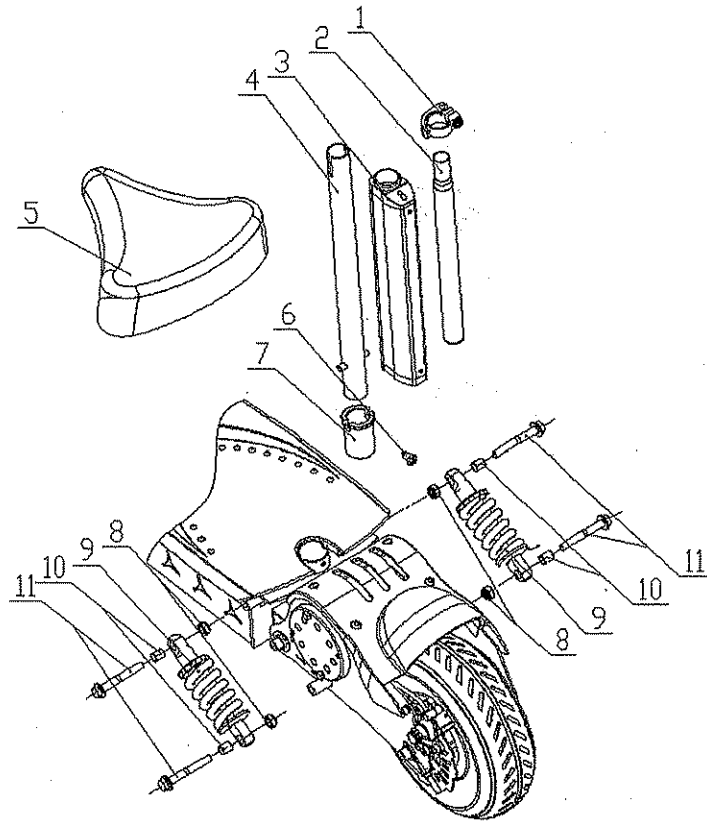

Item	Name	specification/size	QTY
G-1	Seat clip		1
G-2	Seat pole		1
G-3	Seat pole, cover		1
G-4	Seat pole		1
G-5	seat		1
G-6	bolt	M3×6	1
G-7	Seat bush		1
G-8	locknut	M10	4
G-9	Rear shock		2
G-10	spacer	Φ12×Φ10×14	4
G-11	bolt	M10×70	4