



IN230800374V03_US

370-304V80



Max. inflate to 40 psi (280Kpa)

IMPORTANT, RETAIN FOR FUTURE REFERENCE: READ CAREFULLY
Warning. This toy is unsuitable for children under 6 years due to its maximum speed.

ASSEMBLY INSTRUCTION

 **WARNING!**

- Keep this manual for future reference.
- **CHOKING HAZARD** - Small parts. Not suitable for children under 36 months. The product contains small parts, keep children away when assembling.
- **ADULT ASSEMBLY ONLY.**
- Always remove protective material and poly bags and dispose before assembly.
- Protective equipment should be worn. Always wear shoes and sit in the seat when operating the vehicle.
- Only drive on level ground. Never use on the lawn.
- Keep your hands, hair, and clothes away from moving parts.
- Never leave child unattended. Direct adult supervision is required. Always keep child in view when child is in vehicle.
- To reduce the risk of injury, adult supervision is required. Never use in roadways, near motor vehicles, on or near steep inclines or steps, swimming pools or other bodies of water, always wear shoes, and never allow more than 1 rider.
- Never use in unsafe conditions such as snow, rain, loose dirt, mud, sand, or gravel, otherwise may result in an unexpected accident such as tipping over, and could damage the electrical system or battery.
- **WARNING:** Not to be used in traffic.
- This toy should be used with caution since skill is required to avoid falls or collisions causing injury to the user or third parties.
- **WARNING:** This toy is unsuitable for children under 13 years old due to its maximum speed; Maximum user weight is 65kg.
- **WARNING:** This toy has no brake.
- The electric toy shall be regularly examined for damage to the supply cord, plug, enclosure or other parts, and in the event of damage, it shall not be used until the damage has been repaired.
- Use only battery(ies) and charger specified by the manufacturer.

 **BATTERY USAGE WARNINGS**

- Non-rechargeable batteries are not to be recharged.
- Rechargeable batteries are to be removed from the toy before being charged.
- Rechargeable batteries are only to be charged under adult supervision.
- Batteries are only to be charged by persons of at least 8 years old.
- Different types of batteries or new and used batteries are not to be mixed.
- Batteries are to be inserted with the correct polarity(+ and -).
- Exhausted batteries are to be removed from the toy.
- The supply terminals are not to be short-circuited.

WARNING!

The remote control is not a toy. It is for the adult use only, and should not be used by a child. A close adult supervision is always required. Reception range may change significantly with weather, battery, and other environmental conditions.

BATTERY CHARGING WARNINGS

General Safety Warnings

- ⚠ "Read all instructions before using this appliance"
- ⚠ "This appliance can be used by children aged from 8 years and above and persons with reduced physical, sensory or mental capabilities or lack of experience and knowledge if they have been given supervision or instruction concerning use of the appliance in a safe way and understand the hazards involved"
- ⚠ "Children shall not play with the appliance"
- ⚠ "Cleaning and user maintenance shall not be made by children without supervision"

Electrical Safety Warnings

- ⚠ "If the supply cord is damaged, it must be replaced by the manufacturer, its service agent or similarly qualified persons in order to avoid a hazard"
- ⚠ "Do not use outdoors"
- ⚠ "Do not immerse in water or other liquids"
- ⚠ "Disconnect from supply when not in use"

Charger-Specific Warnings

- ⚠ "Use only with batteries specified by the manufacturer"
- ⚠ "Ensure correct polarity when connecting batteries"
- ⚠ "Do not charge damaged or leaking batteries"
- ⚠ "Remove batteries if appliance is not to be used for extended periods"
- ⚠ "Do not short-circuit the output terminals"



Car Body

① x 1



Handlebar

② x 1



Handlebar fixing device A

③ x 2



Handlebar fixing device B

④ x 1



Front wheel

⑤ x 1



Front guard

⑥ x 1



Mudguard

⑦ x 1



Shock absorber

⑧ x 1

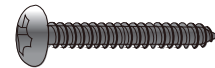

Screw

⑨ x 5



Open spanner

⑩ x 1



L-type Hex wrench

⑪ x 1

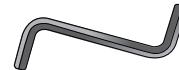

Z-type Hex wrench

⑫ x 1



Hexagonal screw

⑬ x 4

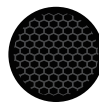

Front guard sticker

⑭ x 1

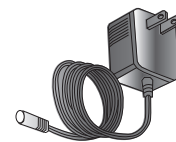

Charger

⑮ x 1



User manual

⑯ x 1

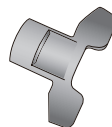

Wrench

⑰ x 1

M8*45

M4*14



9

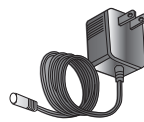

15

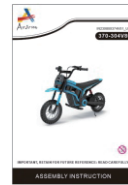

16

Tools:

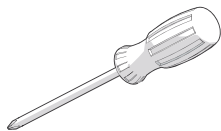

Phillips Screwdriver
(Not Included)



10



11

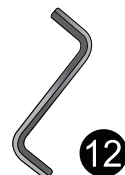

12

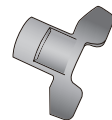

17

Product Specifications:

Battery:	12V 10AH*2
Drive Motor:	24V 350W*1 (3800RPM)
Suitable age:	13+ years old
Maximum weight:	65kg
Car Size:	119*64*76.5cm
Speed:	10-24km/h
Hours of Use:	Using 0.5 hours after Charging 8-12 hours
Charger:	Input: 100V-120V 50/60Hz Output: 24V 1.0A
Fuse:	Auto-reset fuse

Assembly instruction

Adult assembly is required.

Take care of small parts. To prevent a choking hazard, keep small children away when assembling.

Before assembling, count all small parts carefully, ensuring everything is present. Dispose of the plastic bag properly. Do not let children play with the plastic bag.

1.Shock absorber assembly

Remove the shock absorber ⑧ from the spare parts bag. Loosen the two screws (b) and two nuts (a) using the L-type hex wrench ⑪ and Z-type hex wrench ⑫. Insert the shock absorber ⑧ into the car body, as shown in the provided pictures. Then, tighten the two screws (b) and two nuts (a) using the L-type hex wrench ⑪ and Z-type hex wrench ⑫.

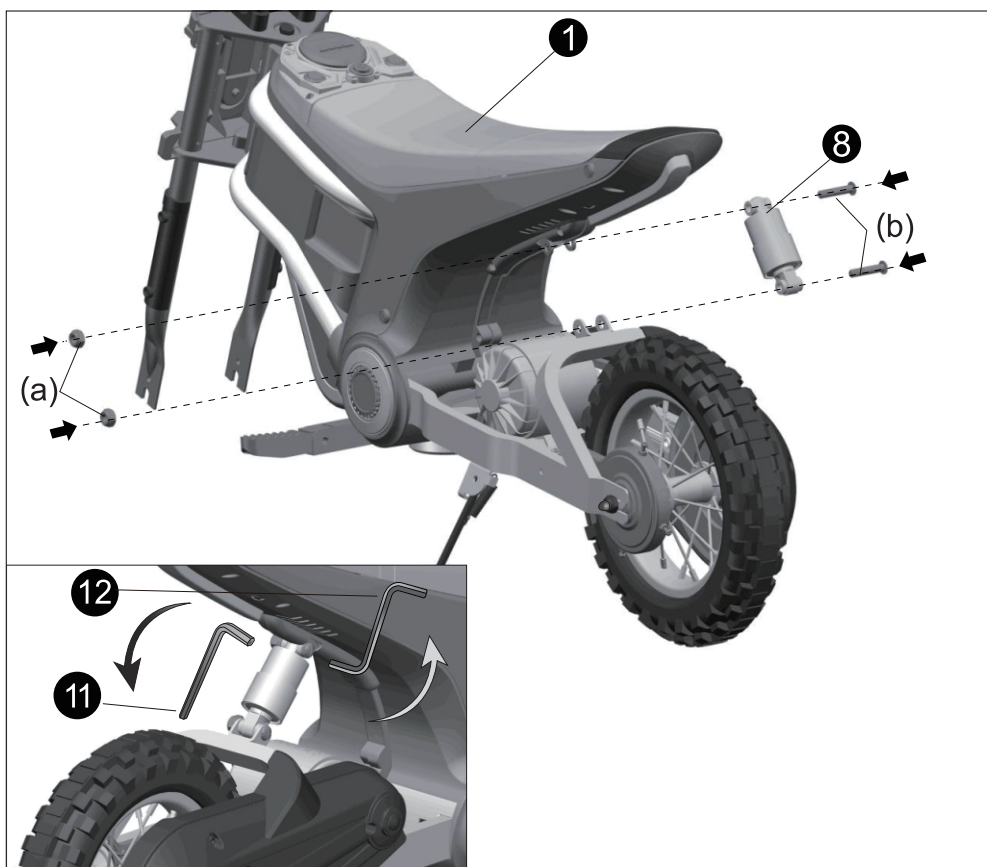

2. Front guard and mudguard assembly

Attach the front guard ⑥ to its correct position on the car body, then fasten it using a M4*14 screw ⑨. Apply the sticker ⑭ onto the front guard ⑥, as shown in the picture. Insert the mudguard ⑦ into the correct position on the car body, then from the bottom, secure it with four M4*14 screws ⑨ using a screwdriver.

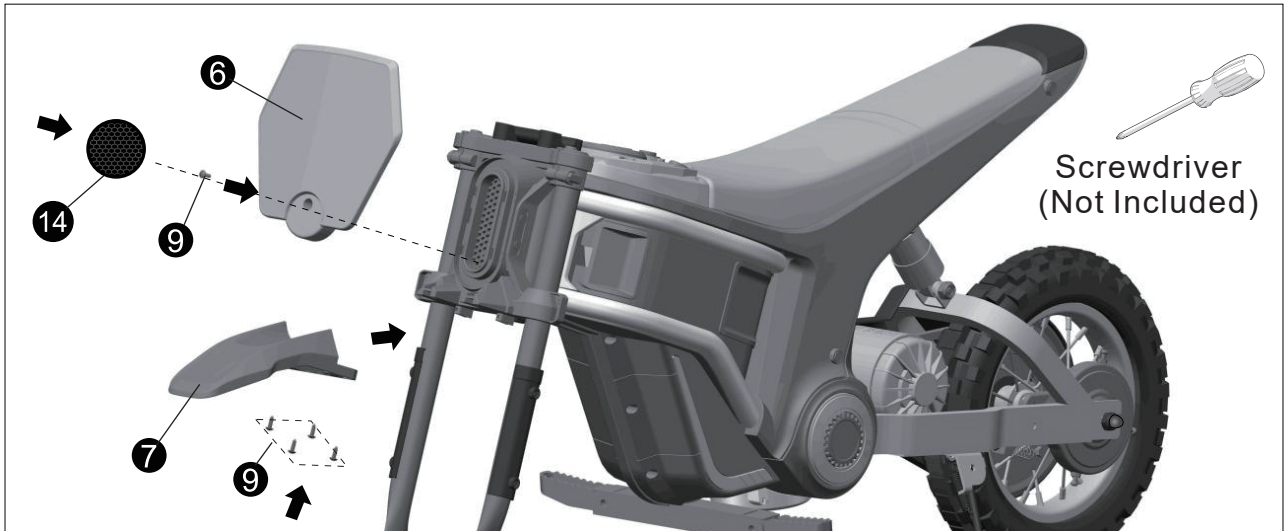

3. Front wheel assembly

Using the wrench ⑰, remove the front axle (A). You will not need the front axle (A) for the next assembly steps.

Loosen the two nuts (C) from the front wheel ④ using the open spanner ⑩, then remove the two washers (B).

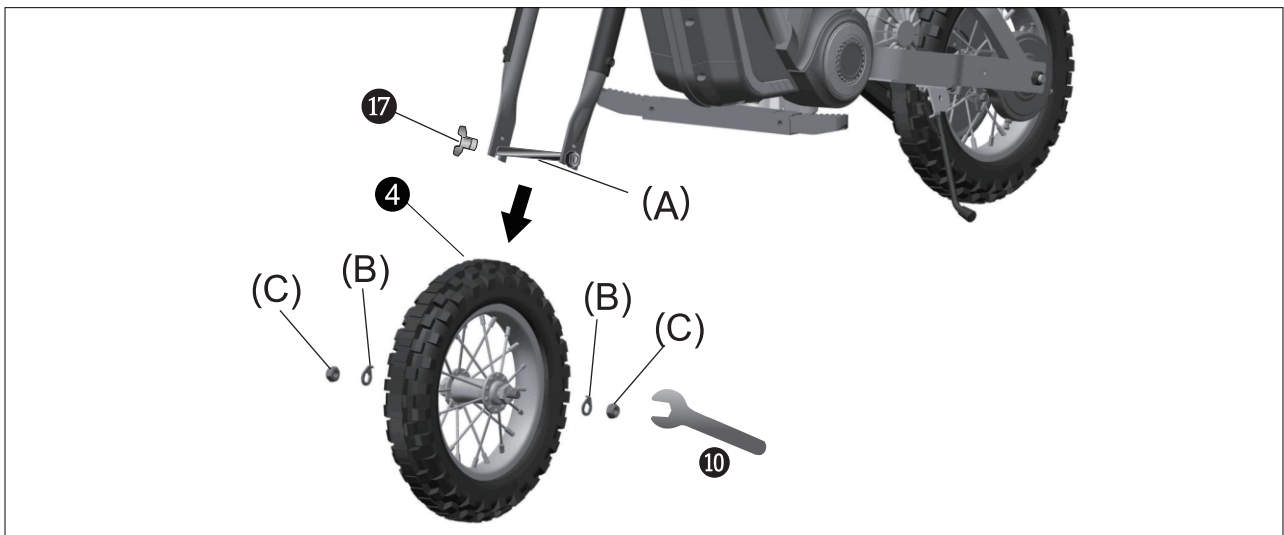

Place the front wheel ④ into the front fork, as shown in the picture. Insert two washers (B) on each side, then secure the front wheel by tightening two nuts (C) using the open spanner ⑩.

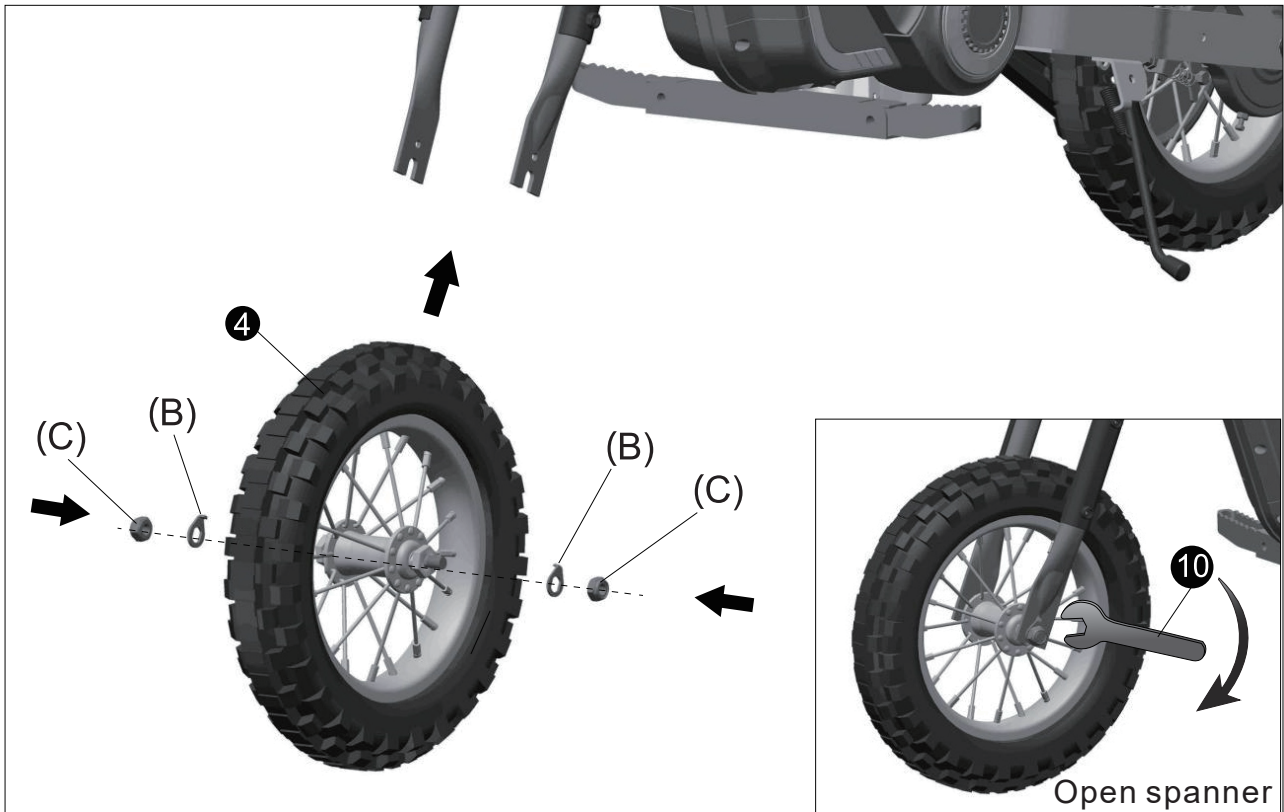

4. Handlebar assembly

Position the handlebar fixing device B ④ over the four holes on the car body. Insert the handlebar ② into place. Attach handlebar fixing device A ③ and insert four M8*45 screws ⑬. Tighten them using the Z-type hex wrench ⑫.

To complete the connection, connect the two plugs from the car body and the handlebar ②.

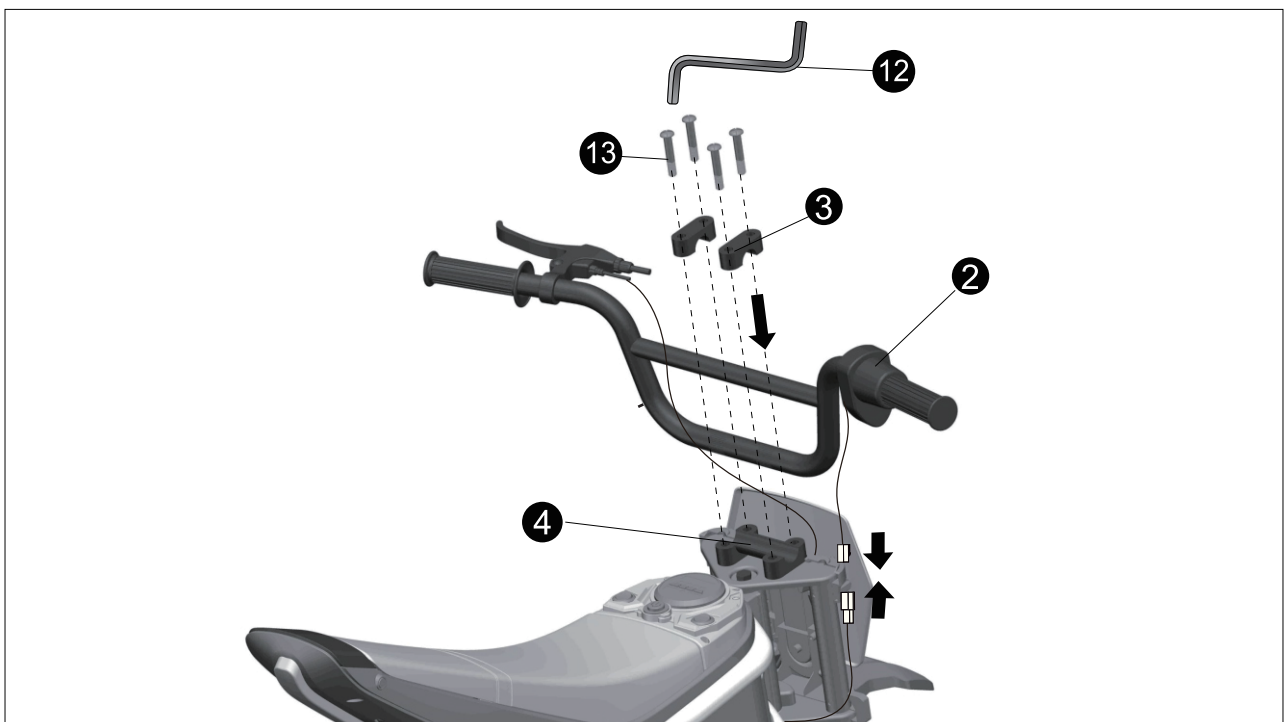

5. Battery connection

Using the screwdriver, loosen and remove the screws (g) from the bottom. Open the seat and connect the power by matching the two red plugs. Using the screwdriver, reattach the seat with two screws (g).

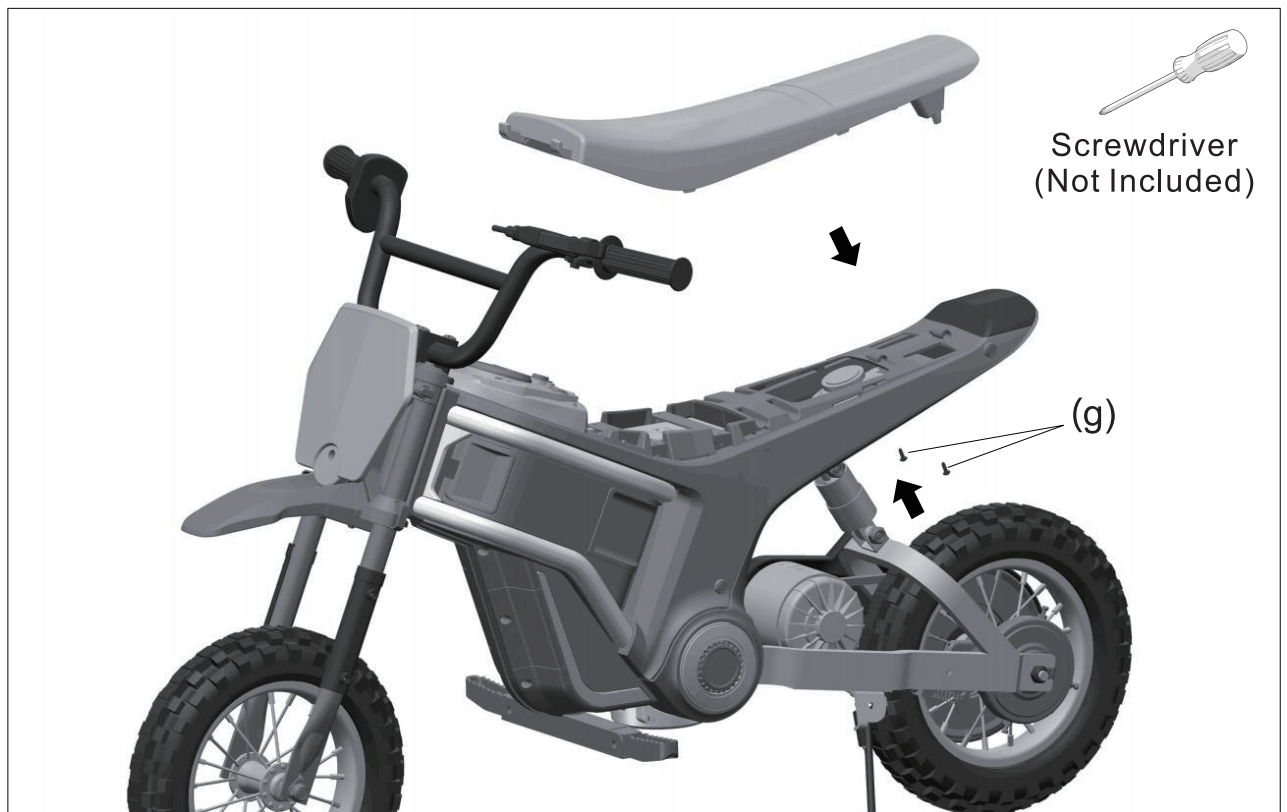
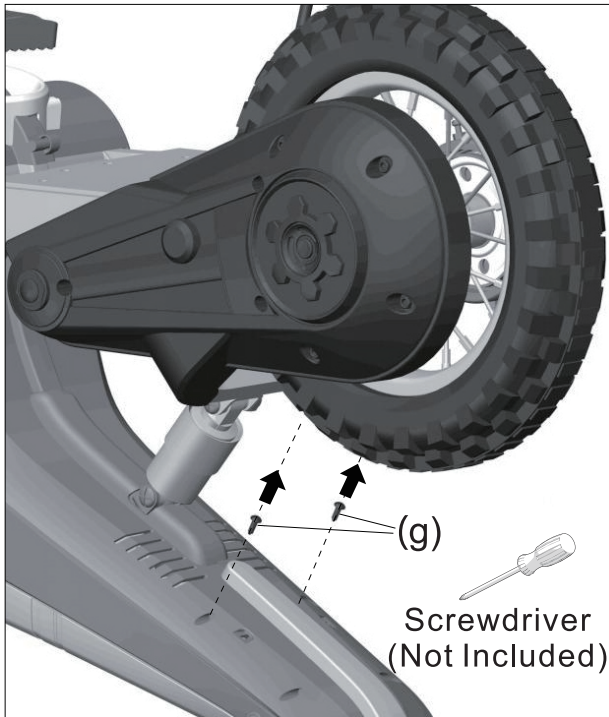

6. Brake adjustment method

(1) Adjusting the brake lever:

- If there is too much travel on the brake, it requires tightening.
- Loosen the white nut (d) on the brake lever by turning it anticlockwise, which tightens the brake.

(2) Adjusting the brake disk nut:

- If the brake still has excessive travel after the lever adjustment, you should focus on the nut (e) near the brake disk.
- Loosen the nut (e) by turning it anticlockwise, which tightens the brake.

(3) Adjusting the brake cable:

- If even after the above adjustments, the brake still has too much travel, you need to check the nut of the brake cable (f).
- Turn the nut of the brake cable (f) anticlockwise to loosen it.
- Tighten the brake cable while holding it in place. Rotate the wheel to assess the level of tightness.
- When you start to feel a slight friction on the wheel, turn the nut of the brake cable (f) clockwise to tighten it.

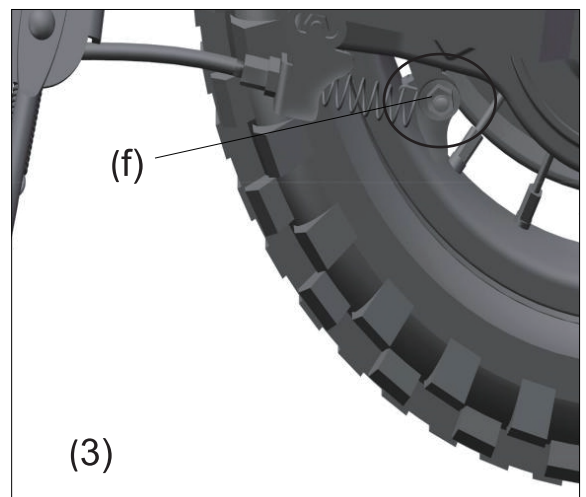
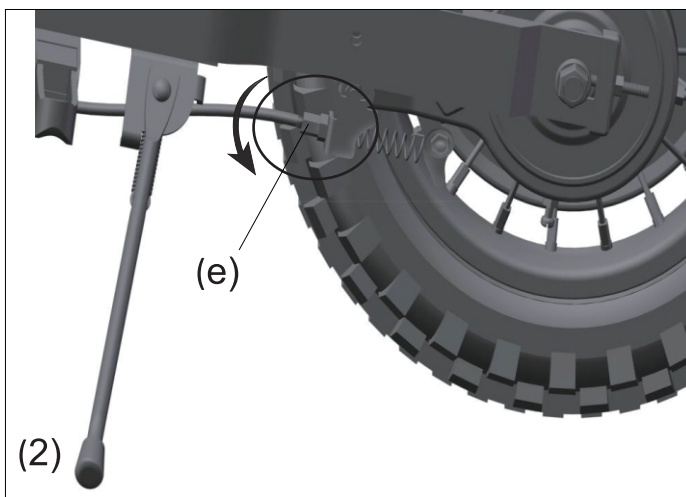
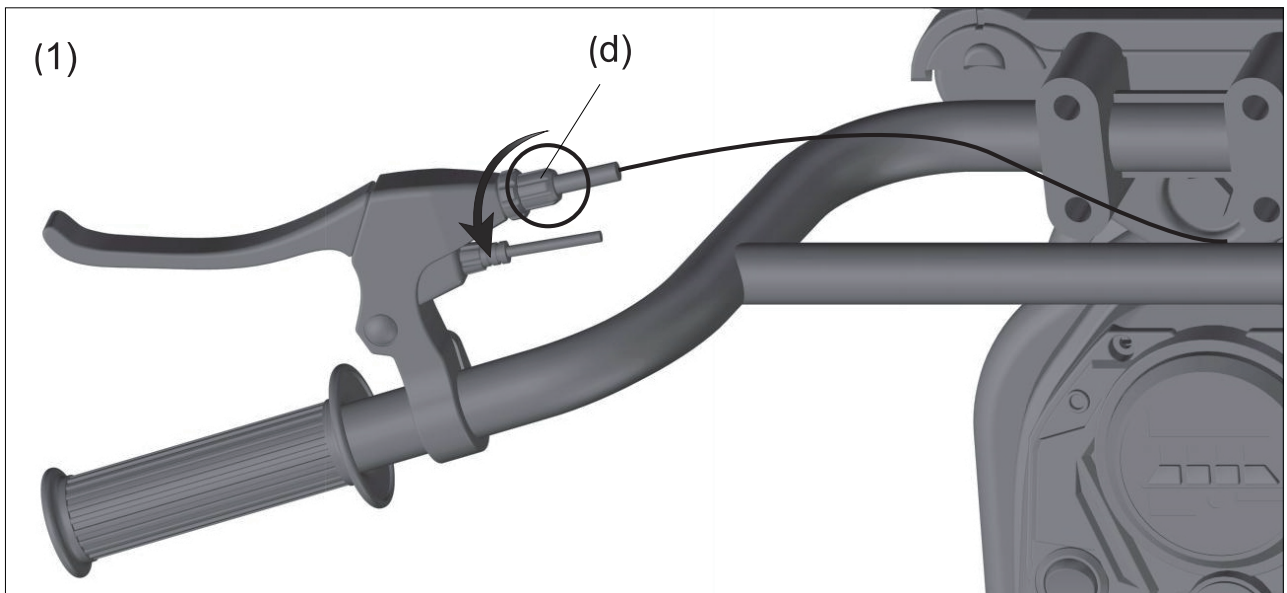

FUSE

The car has an auto-reset fuse. If the car suddenly stops while driving, it is usually due to a sudden surge in current. This causes the fuse to trip automatically.

Turn off the ride-on and do not use for eight seconds, so the fuse can reset. Then, turn on the power again. To avoid the fuse tripping and cutting off the power supply, follow these instructions:

- Do not drag anything behind the ride-on.
- Keep batteries and other electrical components away from water and other liquids.
- Do not alter the circuit system or the structure of the product.

WARNINGS

- Adult assembly is required.
- When unassembled, this product contains small and sharp parts – keep out of the reach of small children.
- Do not use in traffic.
- Warning. This toy is unsuitable for children under 6 years due to its maximum speed.
- This product is not to be used by children under three years of age.
- The seatbelt must be worn when using this product.
- Adult supervision is required when using this product.
- Battery must be charged by an adult. Charge the product before its first use.
- To avoid suffocation, keep packaging out of the reach of children.
- Only use parts provided by the manufacturer.
- Ensure children do not play with the charger.

Note

- Do not use in congested streets, roads, slopes or near drains.
- Do not change the circuit or add electrical devices to the product.
- Do not use the remote control in rain. Keep the car away from water and other liquids to avoid damage.
- The maximum load is 65kg – this product can be used by one child at a time.
- Ensure the power is switched off when not in use. Remove the battery connector when it has not been used for a while.
- Before using and charging, check the plug and other parts for any damage.

Operating(function reference diagram)

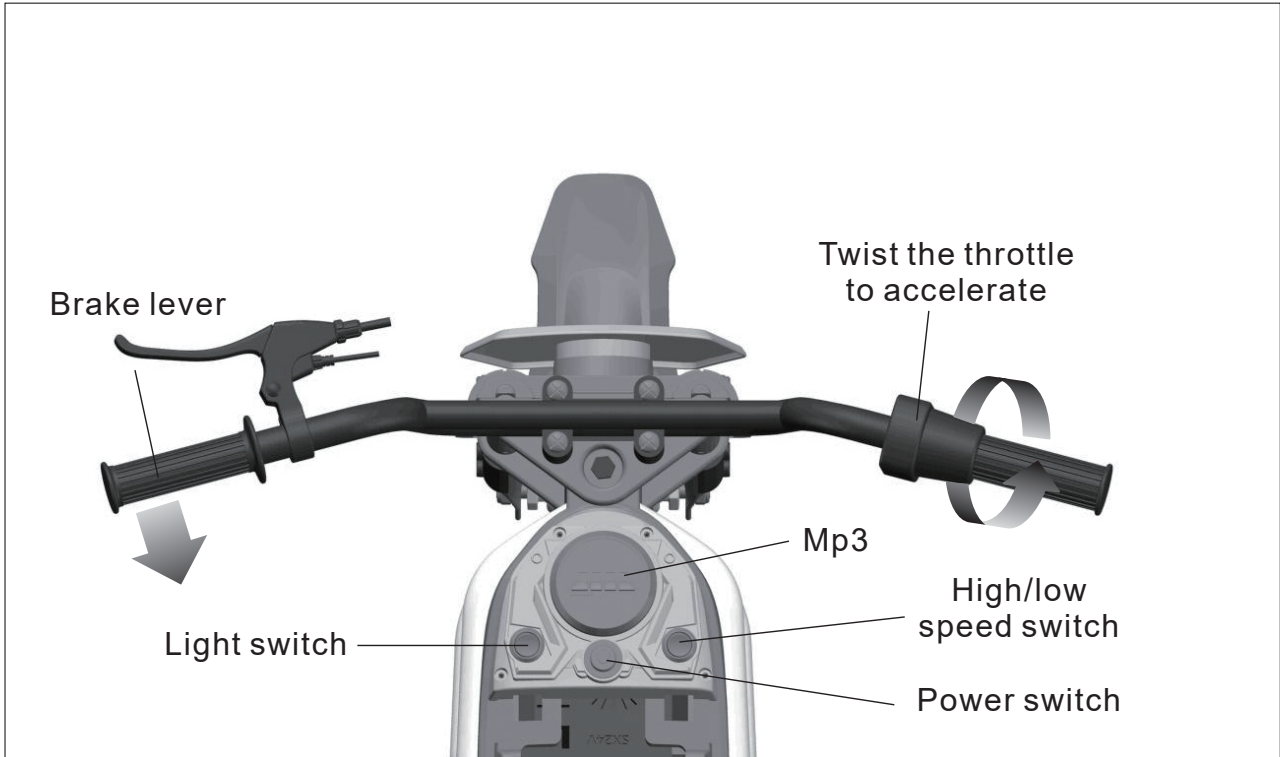

Mp3 player

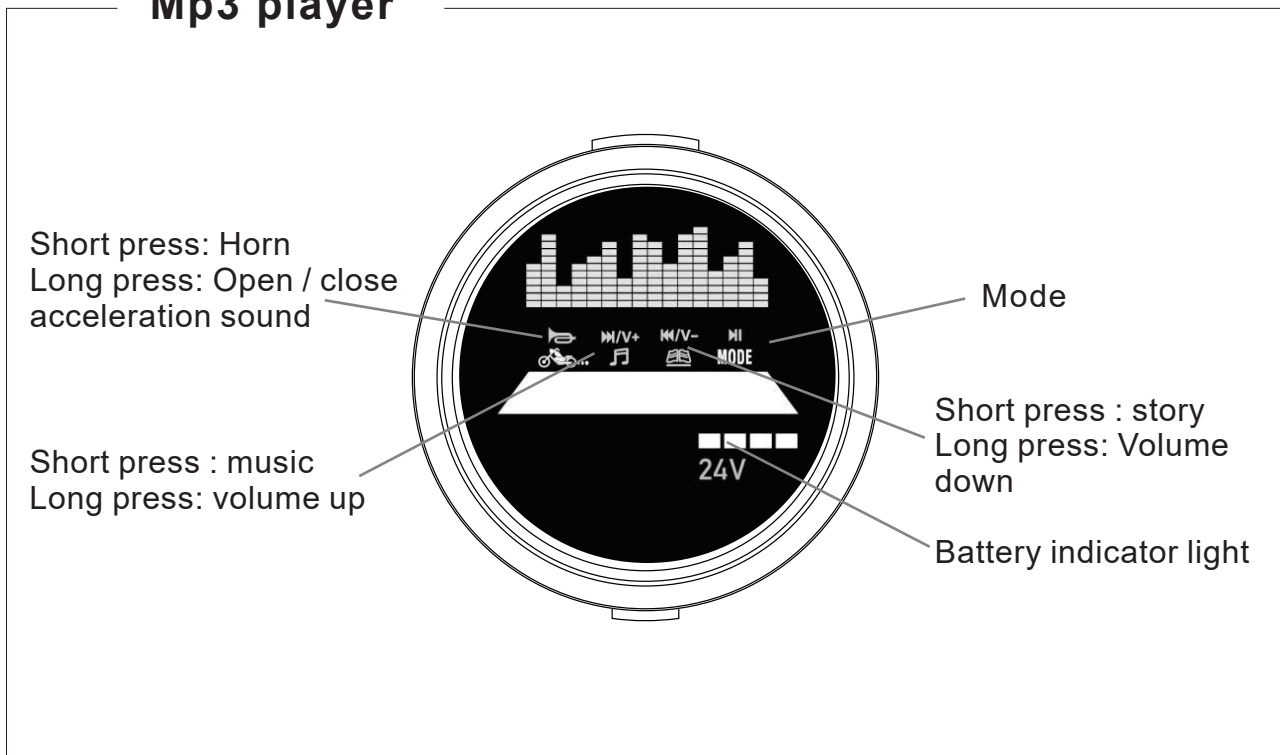

Charging:

- Charge the battery for less than 12 hours – charging for longer can cause permanent damage.
- Place the DC plug into the power socket, then put the charger into the plug. Never use the product while charging.
- This product can be used for 0.5 hours – the charging time is 8-12 hours.
- It is normal for the charger and battery to stay cool when charging.
- Do not use the connector near water to avoid damage.
- Only use the supplied charger. Using a charger, which is not supplied by the manufacturer, can damage the product.
- When not in use for a long time, charge the product.

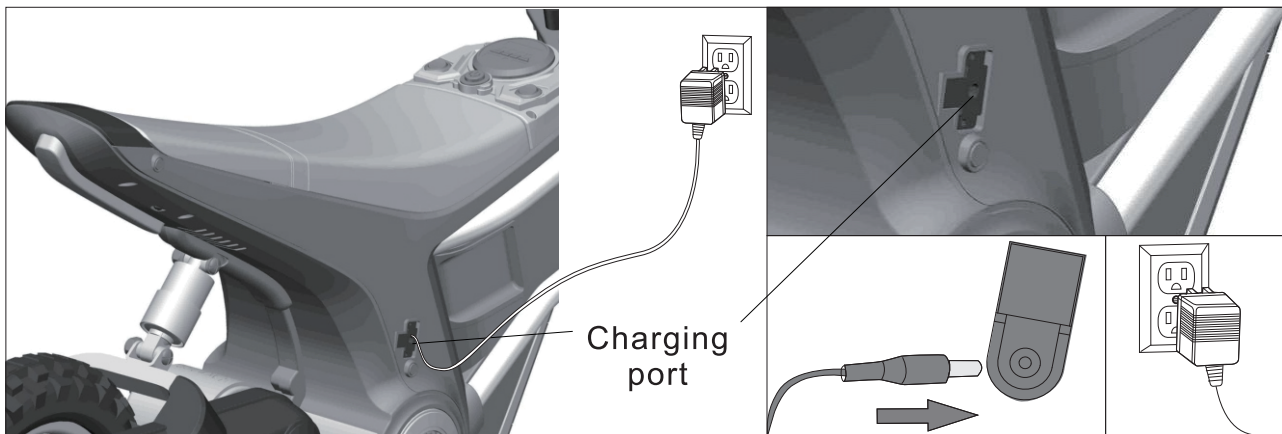

Please follow the instructions to charge the battery.

1. Insert the plug of the charger into the charging port.
2. Insert the charger into the power socket. (The car cannot be started while charging).

Maintenance

- Before using, check the wiring, plug, shell and other parts, ensuring there is no damage.
- When using after a long time, ensure the iron castings are lubricated to avoid rust. When storing, place the product on a flat surface, ensuring it's out of direct sunlight. Keep the product indoors or cover with a water-resistant cloth.
- Keep the product away from stoves, ovens and heaters to avoid plastic from thawing.
- Clean its surface with a dry cloth. Clean plastic parts with non-wax furniture polish.
- Do not clean plastic parts with chemical solutions. Do not clean the car with water.
- Do not drive in wet weather – this could damage the generator, circuit system or battery.
- When not in use, ensure the power is off – the switch should be on 'STOP' or 'OFF'.
- Do not use a fuse that does not conform with the agreed specifications.
- Do not make any modifications to this product or circuit system. Any damages must be fixed by a professional or under the guidance of a professional.

Troubleshooting

Problem	Cause	Solution
The car does not start.	<ul style="list-style-type: none"> - The battery is low. - Failure to press the switch button correctly. - Power connector failure. - Battery breakdown. - Electrical devices are damaged. - Generator is faulty. 	<ul style="list-style-type: none"> - Ensure battery is fully charged. - Follow instructions when using this product. - Reinstall the power connector. - Change battery. - Change electrical devices. - Change generator.
The battery does not charge.	<ul style="list-style-type: none"> - Battery connector failure. - Charger doesn't charge. - Faulty charger. 	<ul style="list-style-type: none"> - Reinstall the connector. - Plug in the charger again. - Change the charger.
The car doesn't drive far.	<ul style="list-style-type: none"> - Battery isn't fully charged. - Overused battery. 	<ul style="list-style-type: none"> - Ensure the battery is fully charged. - Change the battery.
There's a slight noise and the car heats when charging.	<ul style="list-style-type: none"> - This is normal. 	<ul style="list-style-type: none"> - Nothing needs to be done.
The car operates at a slow speed.	<ul style="list-style-type: none"> - Overused battery. - The battery is dead. - The product has exceeded its maximum load. - Uneven driving surface. 	<ul style="list-style-type: none"> - Change the battery. - Ensure battery is fully charged. - Ensure the weight is below 65kg. - Drive on a flat and even surface.

US

If you have any questions, please contact our customer care center.
Our contact details are below:



001-877-644-9366



customerservice@aosom.com

Imported by Aosom LLC
27150 SW Kinsman Rd Wilsonville, OR 97070 USA
MADE IN CHINA

CA

If you have any questions, please contact our customer care center.
Our contact details are below:

Si vous avez la moindre question, veuillez contacter notre centre d'assistance à la clientèle.
Nos coordonnées sont les suivantes:



416-792-6088



customerservice@aosom.ca

Imported by Aosom Canada Inc.
7270 Woodbine Avenue, Unit 307, Markham, Ontario Canada
L3R 4B9
MADE IN CHINA

Importé par Aosom Canada Inc.
7270 Woodbine Avenue, unité 307, Markham, Ontario Canada
L3R 4B9
FABRIQUÉ EN CHINE

