



**⚠ WARNING:** This vehicle was not designed for aggressive riding, racing, or stunt riding of any kind. It will not make extremely sharp turns. Use caution when riding! See inside for additional warnings.



## Razor Jr. Electric Scooter

*Read and understand this entire manual before riding.*

Save this manual with your original sales receipt.

(Specifications subject to change without notice.)

**O w n e r ' s M a n u a l**

## Table of Contents

1. Key Parts of the Razor Jr. . . . .	3
2. Preparing for First-Time Use . . . . .	
2A. Un-box . . . . .	4
2B. Fork and handlebar installation . . . . .	4
2C. Install rear axle and wheels . . . . .	7
2D. Charging prior to use . . . . .	9
2E. Overload protection . . . . .	9
3. Safety Check Before Riding . . . . .	10
4. Maintenance and Repairs . . . . .	10
5. Safety . . . . .	10
6. Illustrated Parts Breakdown . . . . .	12
7. Limited Warranty . . . . .	14



**NOTE:** This manual contains many “Warnings” and “Cautions” concerning the consequences of failing to maintain, inspect or properly use your Razor Jr. Electric. Because any incident can result in serious injury or even death, we do not repeat the warning of possible serious injury or death each time such a warning is mentioned.

**AN IMPORTANT MESSAGE TO PARENTS:** READ THIS ENTIRE MANUAL BEFORE ALLOWING USE OF THE RAZOR JR. ELECTRIC, AND KEEP THIS MANUAL AVAILABLE FOR FUTURE REFERENCE. This manual contains important safety information. For safety, it is your responsibility to review this information and make sure that all children comply with all warnings, cautions, instructions and safety topics and assure that young riders are capable and able to safely and responsibly use this product. Razor USA recommends that you periodically review and reinforce the information in this manual with young riders, and you are required to inspect and maintain your child’s vehicle to insure their safety.

The recommended rider age is only an estimate, and can always be effected based upon a particular rider’s size, weight or skills. If the rider is unable to fit comfortably on the Razor Jr. Electric, don’t attempt to ride it.



**GENERAL WARNING:** Riding the Razor Jr. Electric can be a hazardous activity. Electric vehicles can, and are intended to, move and it is therefore possible to get into dangerous situations and/or lose control and/or fall off. If such things occur you can be seriously injured or die. LIKE ANY OTHER MOVING PRODUCT, USING THE JR. ELECTRIC CAN BE A DANGEROUS ACTIVITY AND MAY RESULT IN INJURY OR DEATH EVEN WHEN USED WITH SAFETY EQUIPMENT AND OTHER PRECAUTIONS. USE AT YOUR OWN RISK AND USE COMMON SENSE.

- Direct adult supervision required.
- Always check and obey any local laws or regulations which may affect the locations where the Razor Jr. Electric may be used on public property. The Razor Jr. Electric is meant to be used only in controlled environments free of potential traffic hazards, and not on public streets or sidewalks. Do not allow your children to ride the Razor Jr. Electric on public streets or in any areas where pedestrian or vehicle traffic may present a risk of collision or injury to the child or others. Watch out for potential obstacles including pedestrians, skaters, skateboards, bikes, children or animals who may enter your path, and respect the rights and property of others.
- Do not allow the Razor Jr. Electric in wet weather and never immerse the Razor Jr. Electric in water, as the electrical and drive components of the Razor Jr. Electric could be damaged by water or create other possibly unsafe conditions.
- The Razor Jr. Electric is designed to perform best outdoors on solid, flat, clean and dry surfaces. Wet, slick or uneven and rough surfaces may impair traction and contribute to possible accidents. Use only on flat, dry, level ground without loose debris, such as rocks or gravel. Do not allow the Razor Jr. Electric in mud, ice, puddles or water. Avoid excessive speeds that can be associated with downhill rides. Never risk damaging indoor surfaces such as carpet or flooring by use of a Razor Jr. Electric indoors. Razor will not be responsible for damage to floors, walls, furniture, etc., if the vehicle is used indoors.
- Do not ride at night or in impaired visibility conditions.

- Always wear proper protective equipment, such as an approved safety helmet, elbow pads and kneepads. A helmet may be legally required by local law or regulation in your area, and should always be worn when riding a Razor Jr. Electric. Always wear shoes, never ride barefooted or in sandals, and keep shoelaces tied and out of the way of the wheels, motor and drive system.
  - The electric motor in your Razor Jr. Electric can become hot when in use. Do not touch the motor and handle the Razor Jr. Electric carefully.
  - Do not exceed the weight limit of 40 pounds/18 Kg (see warning on back page). The Razor Jr. Electric is not recommended for children under 2 years of age.
  - Do not allow stunts or tricks on the Razor Jr. Electric. The Razor Jr. Electric is not made to withstand abuse from misuse such as jumping, grinding or any other type of stunts.
  - REFER TO SECTION 5 ON PAGE 10 FOR ADDITIONAL, CRITICAL WARNINGS.
- FAILURE TO USE COMMON SENSE AND HEED THE ABOVE WARNINGS FURTHER INCREASES RISK OF SERIOUS INJURY. USE AT YOUR OWN RISK AND WITH APPROPRIATE AND SERIOUS ATTENTION TO SAFE OPERATION. USE CAUTION.

## 1. Key parts of the Razor Jr. Electric

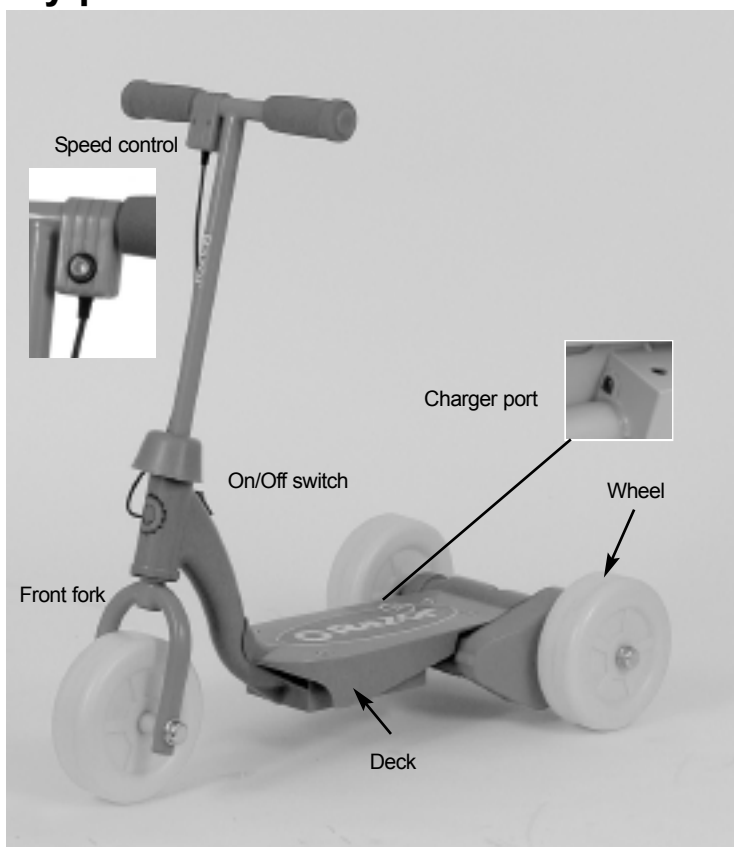

**NOTE: Do not activate the speed control on the handlebar unless the rider is steadily positioned on the Razor Jr. Electric and in a safe, outdoor environment. Use this product only in areas free of potential traffic hazards and not on public streets or sidewalks.**



**WARNING: REGARDING USE OF NON-RAZOR PRODUCTS WITH YOUR RAZOR RAZOR JR. ELECTRIC.** The Razor Jr. Electric has been built to certain Razor design specifications. The original equipment supplied at the time of sale were selected on the basis of their compatibility with the frame, fork and all other parts. Certain after-market products may or may not be compatible. Consult your retailer or call Razor prior to modifying or replacing any component with a non-factory specified product.



**WARNING: CHECK LOCAL LAWS REGARDING USE.** Check local laws and regulations to see where and how you may use the Razor Jr. Electric legally. In many states and local areas, riders are required BY LAW to wear a helmet. Check local laws and regulations regarding laws governing helmet use, age and vehicle operation in your area.

### TOOLS REQUIRED FOR ASSEMBLY

- Adjustable wrench or 13mm box wrench
  - Hammer
- Razor recommends assembly by an adult with experience in bicycle mechanics. Some tools may be supplied, however we recommend the use of mechanic's grade tools. Use the supplied tools only as a last resort.*



**WARNING:** Failing to properly tighten the steering clamp that affix the forks can cause the rider to lose control and fall.



**WARNING:** Failing to properly install the axle retainers can cause the rider to lose control and fall.

## 2. Preparing for First-Time Use

**2A. Un-box.** Remove contents from box. Remove the foam separators that protect the various components from damage during shipping. Inspect the contents of the box for scratches in the paint or dents that may have occurred during shipping. The Razor Jr. Electric was 95% assembled and packed at the factory to prevent shipping damage and there should not be any problems, even if the box has a few scars or dents. But if there are, contact Razor USA, toll free, at (866) 467-2967 to resolve any problems.



**NOTE:** With proper tools at hand, allow approximately twenty minutes for assembly.



**WARNING:** In the unassembled state, this package contains small parts. Adult assembly is required. Children should not handle parts of help in the assembly of the scooter.

**2B. Fork and handlebar installation.** If not already preinstalled, slide a steering bushing on to the fork as shown in Figure 2. Both bushings are the same, but the bushing on the bottom interlocks with a key in the frame and a peg on the fork to limit the steering (see arrow in Figure 2).



*Figure 2. Steering bushing and fork. Align the slot with the peg (arrow).*

Slide the fork into the frame and install the second steering bushing (A) and steel washer (B) as shown in Figure 3a. Install the clamp as far as it will go as shown in figure 3b.



*Figures 3a and 3b.*



**NOTE:** Refer to the illustrated parts diagram on page 13 for a detailed exploded view of the assembly.

Slide the handlebar into the fork. Be careful not to stretch the wire between the speed control button and the frame. If necessary, lower the fork to provide more clearance to insert it into the frame, but readjust the bushing as shown in Figure 3a and 3b. Tighten the clamp as shown in Figure 4a. While holding the wire to prevent it from coming out of the switch (Figure 4b, "A" ), slide the cover figure (Figure 4b, "B") over the clamp as shown.

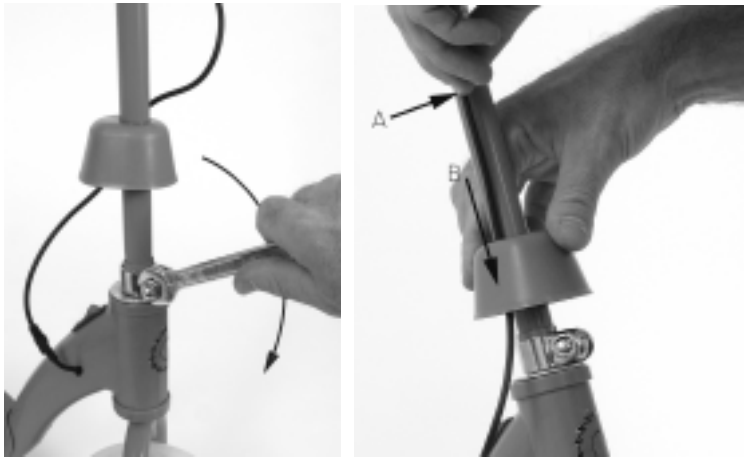

*Figures 4a and 4b.*



*Figure 5.*

When correctly assembled, the handlebar, fork and front wheel should appear as shown in Figure 5.



*Figure 6. Steering test.*

Test the steering function. The handlebars should steer freely, but the turning should be limited to about 45 degrees left and right as shown in figure 6.



**NOTE:** Although we make every effort to keep our manual up-to-date, if your Razor Jr. Electric does not look exactly this, then we've made improvements since this document was printed. Check out the Razor website: [www.razor.com](http://www.razor.com) for technical updates on the latest service and adjustment procedures.

**2C. Install the rear axle and wheels.** The motor drives the left rear wheel via a gear train located in the gear box adjacent to the rear wheel. The left rear wheel has a coupling that engages the gearbox.

The retainer cap is pre-installed on the left side of the axle. Slide the axle through the wheel and insert the rear axle so the power coupling on the wheel engages the coupling on the left-side as shown in Figure 7.

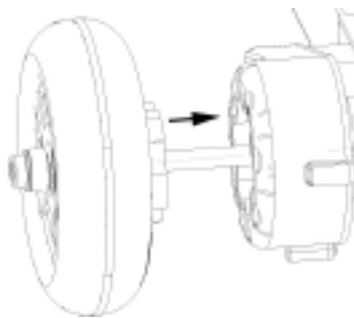

*Figure 7*

Slide the rear axle through the scooter body as shown in Figure 8. Position the plastic spacer and flat washer as shown in Figure 8.

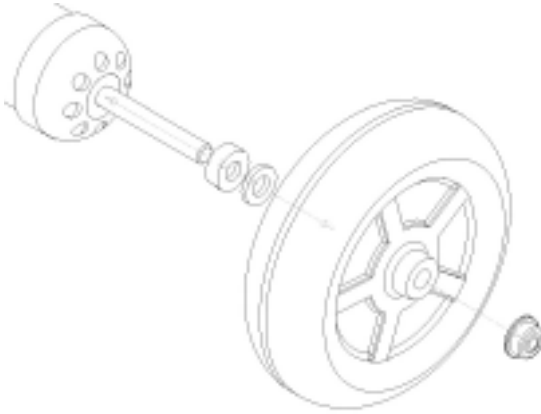

*Figure 8*

Slide the wheel onto the axle. Position the retaining cap over the axle and, using the plastic installing tool provided to protect the cap, hammer the retaining cap as far as it will go onto the axle as shown in Figure 9. Remove the installing tool.



*Figure 9.*

*Using the installing tool, use a hammer to set the axle retainer in place as far as it will go.*



**2D. Charging the battery prior to use.** Your Razor Jr. Electric may not have a fully charged battery at the time of purchase. Therefore it is a good idea to charge the battery prior to use. The charging input is located under the deck as shown in Figures 10a and 10b.



*Figures 10a and 10b*

The charger unit has two LEDs to indicate the charge status, usually red for charging and green for charged.

Refer to the label on the charger case unit for the actual “charging” and “charged” status indications for your model charger. The initial charge may take from a few minutes to up to 8 hours depending on the level of depletion.

Use **ONLY** with the recommended charger. The charger is not a toy. Never allow young children to charge the scooter. A young child could inadvertently be injured by the electricity involved in charging the scooter.

If cleaning your electric scooter with liquid, always disconnect from the charger before cleaning.



**NOTE:** The battery should last approximately 200 to 500 charge cycles. Various factors effect battery life, including discharging to extremely low levels. When the scooter slows or noticeably loses power (20 to 40 minutes run time on a full charge), recharge before continuing use.

**2E. Overload protection.** The electrical circuit is designed to automatically shut off the power in the event an overload condition is placed on the motor. An excessive overload, such as too heavy a rider or too steep a hill, could cause the motor to overheat. If the Razor Jr. Electric suddenly stops running, wait a few minutes and then turn the on-off switch to reset the circuit. Avoid whatever conditions caused the overload.

## 3. Safety Check Before Riding

**3A. Loose parts.** While straddling the Razor Jr. Electric , lift the front up one or two inches and let go so it can bounce on the ground. Does everything sound tight? There should not be any unusual rattles or sounds from loose parts or broken components. If you are not sure, ask an experienced mechanic to check.

**3C. Frame, fork and handlebars.** Check for cracks or broken connections. Although broken frames are rare, it is possible for an aggressive rider to bash into a curb or wall and wreck and bend or break a frame, fork or handlebar. Get in the habit of inspecting yours regularly.



**CAUTION:** This product moves when used. Direct adult supervision required at all times. Exercise caution and common sense.

## 4. Maintenance and Repairs



**NOTE:** Wheels are subject to normal wear and tear. It is the responsibility of the parent to periodically inspect the tires for excess wear and tear.

Replacement wheels may be obtained from Razor USA. If changing wheels, be sure to order replacement axle retainer caps as detailed in the illustrated parts breakdown. For technical assistance or spare parts, call Razor USA toll free (866) 467-2967.

## 5. Safety



**WARNING:** The child must maintain a hold on the handlebars with both hands at all times. ***Do not allow more than one child at a time on this product. Never use near steps or swimming pools.***



**WARNING:** Keep your fingers and other body parts away from the drive chain, steering system, wheels and all other moving components.



**WARNING TO PARENTS:** Kids need to be taught and be frequently reinforced of the importance of safe riding, the rules of the road and the importance of avoiding using the Razor Jr. Electric on streets due to dangers and hazards of traffic, especially motor vehicle traffic. Parents and children are urged to read and understand these safety tips together.

Ride defensively. Assume that pedestrians and others are so absorbed in their own world that they are not paying any attention to you and that they will run you down or step out in front of you, all without any warning.

Watch for obstacles such as pot holes, sewer grates, expansion cracks, and road or construction debris (such as nails or other foreign objects) that could catch your wheel or force you to swerve lose control.

Never ride with headphones or use a cell phone when riding.  
Never carry a passenger. Never hitch a ride with another vehicle.

Riding an Razor Jr. Electric may be a hazardous activity and has inherent dangers that no amount of care, caution, instruction or expertise can eliminate. Certain conditions may cause the equipment to fail without fault of the manufacturer. Activities involving the use of electric vehicles carry the risk of injury or death.

The transformer/charger supplied with the electric scooter should be regularly examined for damage to the cord, plug, enclosure and other parts, and, in the event of such damage, the scooter must not be charged until it has been repaired or replaced.

Use ONLY with the recommended charger. The charger is not a toy. If cleaning your electric scooter with liquid, always disconnect from the charger before cleaning.



**NOTE: BATTERY CARE AND DISPOSAL.**

**CARE:** If a battery leak develops, avoid contact with the leaking acid and place the damaged battery in a plastic bag. Refer to the following disposal instructions.

If acid comes into contact with skin or eyes, flush with cool water for at least 15 minutes and contact a physician.

Do not store the battery in temperatures above 75° or below -10° F.

**DISPOSAL:** Your Razor product uses sealed lead-acid batteries. They must be recycled or disposed of in an environmentally sound manner.

Do not dispose of a lead-acid battery in a fire. The battery may explode or leak.

Do not dispose of a lead-acid battery in your regular household trash. The incineration, landfilling or mixing of sealed lead-acid batteries with household trash is prohibited by law in most areas.

Return exhausted batteries to a federal or state approved lead-acid battery recycler or a local seller of automotive batteries. If you live in the State of Florida or Minnesota, it is prohibited by law for anyone to throw away lead-acid batteries in the municipal waste stream.

## 6. Illustrated Parts Breakdown (Figure 11)

<i>Item</i>	<i>Qty</i>	<i>Description</i>
1.	2	plug bar end
2.	2	grip foam
3.	1	trigger sw2
4.	1	steel t bar welded
5.	1	cover steering clamp
6.	1	bolt for clamp
7.	1	washer for clamp
8.	1	nut for clamp
9.	1	clamp steering
10.	1	washer headset
11.	2	steering bushing
12.	1	main frame right
13.	1	main frame left
14.	1	fork steel welded
15.	2	cap axle
16.	4	spacer front axle
17.	2	wheel non-driven
18.	1	switch1
19.	1	battery
20.	1	motor with gear
21.	1	gear cover back plate
22.	1	gear 10t 1.5m
23.	1	gear with power coupling
24.	1	gear 10t 1.0m
25.	1	gear cover outside housing
26.	1	wheel coupler driven
27.	2	cap axle
28.	1	washer
29.	1	spacer rear axle
30.	1	axle rear steel
31.	1	axle cover right
32.	4	screw 3mm x 15mm self tap
32.	8	screw self-threading
34.	1	axle front steel
35.	1	charge input plug, not shown
36.	1	charger, not shown
37.	1	Electronic control board, not shown
38.	1	deck, not shown
39.	1	motor cover

*(Specifications and parts list subject to change without notice. Parts shown for reference only. Not all parts or components are available as spares.)*



Figure 11. Illustrated parts breakdown

## 8. Razor Limited Warranty

The manufacturer warrants this product to be free of manufacturing defects for a period of 90 days from date of purchase. This Limited Warranty does not cover normal wear and tear, tires, tubes or cables, nor any damage, failure or loss caused by improper assembly, maintenance, storage or use of the Razor Razor Jr. Electric.

This Limited Warranty will be void if the product is ever:

- used in a manner other than for recreation or transportation;
- modified in any way;
- rented.

Check local laws and regulations to see where you can ride your Razor Jr. Electric legally.

The manufacturer is not liable for incidental or consequential loss nor damage due directly or indirectly from the use of this product.

***To obtain service under this warranty you must, within the warranty period, contact Razor USA LLC directly by e-mail at [warranty@razorusa.com](mailto:warranty@razorusa.com). Razor will provide warranty replacement at its sole discretion. Authorized warranty service is ONLY available from Razor USA LLC.***

*SB 1918 (California) declaration:*

***YOUR INSURANCE POLICIES MAY NOT PROVIDE  
COVERAGE FOR ACCIDENTS INVOLVING THE USE OF THIS  
SCOOTER/ELECTRIC VEHICLE. TO DETERMINE IF  
COVERAGE IS PROVIDED, YOU SHOULD CONTACT YOUR  
INSURANCE COMPANY OR AGENT.***

## QUESTIONS?

Please read the owner's manual thoroughly. If you still have questions, check our website for updates and contact information.

Spare tires, tubes and batteries are available! Keep your Razor Razor Jr. Electric running for years with these and other genuine Razor parts.

Visit our website and e-mail us for more information on spare part availability.

**Specifications subject to change without notice.**

Patent Pending

Rev. 7/08/04 © Copyright 2004 Razor USA. All rights reserved.

Photos by Arthur Cambridge

**IMPORTANT! IF YOU HAVE A PROBLEM WITH YOUR SCOOTER ,DO NOT RETURN TO STORE**

For warranty assistance, call Razor USA Toll Free  
(866) 467-2967



**WARNING:** If the battery ever requires replacement, discard of the battery at your local battery recycling center. Do not discard in the municipal trash or recycling. The battery is a 6 volt sealed, lead-acid type battery.



**WARNING: WEIGHT LIMIT**

40 pounds/18 Kg maximum rider weight limit. Heavier riders may cause damage not covered by warranty. **DO NOT ALLOW YOUR CHILD TO RIDE UNLESS HE/SHE CAN SAFELY RIDE AND CONTROL THE RAZOR JR. ELECTRIC.** Rider weight does not necessarily mean a persons' size is appropriate to fit or maintain control of the Razor Jr. Electric. Read additional warnings inside this manual.

